

Bright 17 Ft Two Birth (Aluminum Frame)

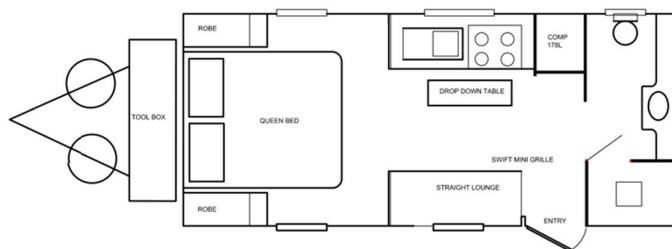

CONTACT US:
0470 254 765 - Amila
info@greatalpinecaravans.com.au
www.greatalpinecaravans.com.au
a



Standard Touring Van Weights & Dimensions

CABIN LENGTH: 17 FT

OVERALL LENGTH: 6.5M

WIDTH: 7.8FT (2.4M)

HEIGHT: 9.67FT (2.95M) INTERNAL

HEIGHT: 1975mm GTM: 2020 KG (APP)

TARE: 1680 KG (APP)

ATM: 2200 KG (APP)

TOW BALL: 180 KG (APP) PAYLOAD: 400 KG (APP)

EXTERIOR

- 12ft Roll out awning (with centre support bracket)
- Triple lock door with fly screen
- Large, checker plate-covered tunnel boot
- Reverse camera with 6" monitor
- Double-glazed windows
- 1 x LED skylight hatches
- External picnic table
- Winegard Sensor antenna
- 2 x external LED lights
- LED taillights
- External speakers
- External 240V point
- External 12V point
- Pull Out Step
- External door handle light
- Chrome grab handles

CHASSIS

- Supergal Boxed Chassis 4"
- A-Frame
- 2" raiser
- Chassis-mounted checker plate battery boxes
- 235 / 15" All Terrain tyres & rims
- Roller Rocker Suspension
- 12" electric brakes on all wheels with a breakaway unit
- 50mm coupling with handbrake.
- 2 x arm bumper
- 1 x spare Tyre 15" matching alloy
- Drop-down legs.
- Jockey wheel
- Mudflaps
- 2 x safety chains
- Jacking point on chassis

INTERNAL

- RV Queen-size bed with innerspring mattress (6'2" x 5')
- Full Ensuite with separate shower and toilet
- Straight seating in soft vinyl with hand-stitched upholstery
- Double-glazed windows with inbuilt privacy & fly screens
- 2 x LED skylights (Toilet and shower)
- Fully integrated kitchen with ball-bearing runner drawers
- Push button catches and top doors with hidden locks.
- Bathroom pack (towel rail & toilet roll holder)
- Crome tapware
- Ceramic ensuite vanity basin Internal
- LED lights Reading lights to bed and dinette.

- Queen bed on struts with underneath storage.
- TV swivel bracket
- Laminated bench tops
- Smoke detector and fire extinguisher.
- Queen Bed Side Pigeonholes
- USB Points to Queen Bed and Dinette

CONSTRUCTION

- Aluminium Frame
- One-piece fibreglass roof
- Honeycomb flooring.
- 560mm high side black checker plate
- Allicom panel
- Insulated walls and roof
- Aluminium H frame to A/C for added strength.
- 15.5mm white matt ply CNC cut furniture throughout with solid timber (PVC Base)
- One-piece moulded shower
- Laminated panel inside shower partition (no ply) • All furniture is stapled and screwed for extra strength.
- 3mm PVC Ply internal walls and roof

APPLIANCES & ELECTRICAL

- Full Swift mini grill 3 gas & 1 electric plus
- 12V range hood with light and fan
- NCE 20-litre Microwave
- Furrion stereo
- NCE DVD / multimedia player receiver & Bluetooth
- 1 x 100 AMP Lithium Battery
- 2 x 230w roof-mounted solar panel
- Victron components
- 178-litre Thetford compressor fridge
- 12-pin flat trailer plug with fridge operation
- 12v Anderson plug for accelerated charging
- Power points throughout
- 24" Google TV
- Gree Air A/C 2.8kw
- 2 x 12v exhaust fans to shower and toilet.
- 2-way electrical circuit – master bedroom to toilet

PLUMBING

- Thetford swivelling toilet & cassette.
- External shower
- External gas bayonet
- 2 x 95-litre water tanks
- 2 x 9 KG gas bottles on A-frame
- 28-liter Swift gas & electric hot water service
- 2 x Lockable water filler Mains pressure inlet
- Wastewater to a common outlet
- Tap on A-frame Filtered Water
- 3-way filtered water
- 12V water pump

Extras

- Dust Extractor
- Washing machine
- Do 35 Hitch
- Inverter
- Sirocco fans
- Fantastic Hatch
- Diesel heater
- Instantaneous hot water
- Slideout kitchen
- Grey water tank
- Bike rack
- BBQ slider
- Wood box
- Jerry cans
- Anex
- Roof rafters
- 16-inch wheel
- Off-road independent suspension
- Double aluminium pull-out step